



# Form Ties

Fast to install, easy to cut and durable. The machine threaded form ties are manufactured using glass fibre-reinforced polymer (GFRP) composites.

## Advantages:

- High durability
- Easy to cut
- High moisture absorption resistance
- Thread profile strength
- Concrete-coloured rod

## Specifications

Tie Rod Specifications	
Size (diameter)	16mm
Colour	Concrete Grey
Nut strength average	65 kN
Nut strength guaranteed	55 kN
Shear strength average	45 kN
Shear strength guaranteed	40 kN
Nut size	
Length	75mm
Diameter of washer face	65mm
Hex size for spanner	32mm / 1 ¼"

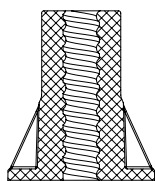

SECTION B-B

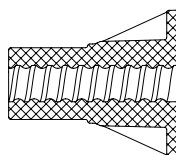

SECTION A-A

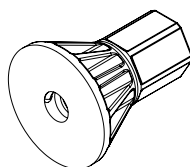

## Contact us

Get the benefits of GFRP form ties on your next project?

email: [brenda@pultron.com](mailto:brenda@pultron.com) or call: **06 867 8582**

Pultron products are sold subject to Pultron's standard warranty and nothing here in shall expand or extend such warranty. The data contained herein is considered representative of present production and believed to be reliable. Pultron Composites Limited reserves the right to make improvements in the product and process which may result in benefits and/or changes to some physical and mechanical properties.

HEALTH & SAFETY INSTRUCTIONS: Only cut this material after referring to the MSDS and wearing PPE breathing apparatus including a P2 mask as this material produces silica dust when cut.