

MACMAT R
LEGEND

- SHEET 01 TYPICAL ROAD EMBANKMENT PROTECTION
- SHEET 02 TYPICAL SLOPE PROTECTION
- SHEET 03 INSTALLATION DETAILS (1): OVERLAPPING
- SHEET 04 INSTALLATION DETAILS (2): FIXING

| Rev: | Observations | Dis: | App: | Date: |
|------|--------------|------|------|-------|
| | | | | |



Table

TYPICAL ROAD EMBANKMENT PROTECTION

STANDARD DIMENSIONS TABLE - MACMAT R

| PRODUCT | MESH TYPE | WIRE DIAM. | COATING TYPE |
|-----------------|-----------|----------------|----------------------------|
| MACMAT R6822 GN | 6 x 8 | Ø 2.2mm | GALFAN |
| MACMAT R6822 G0 | | Ø 2.2mm/3.2 mm | GALFAN + POLYMERIC COATING |
| MACMAT R8127 GN | 8 x 10 | Ø 2.7mm | GALFAN |
| MACMAT R8127 G0 | | Ø 2.7mm/3.7 mm | GALFAN + POLYMERIC COATING |

NOMINAL DIMENSIONS OF HEXAGONAL STEEL WIRE MESH ACCORDING TO ASTM 975

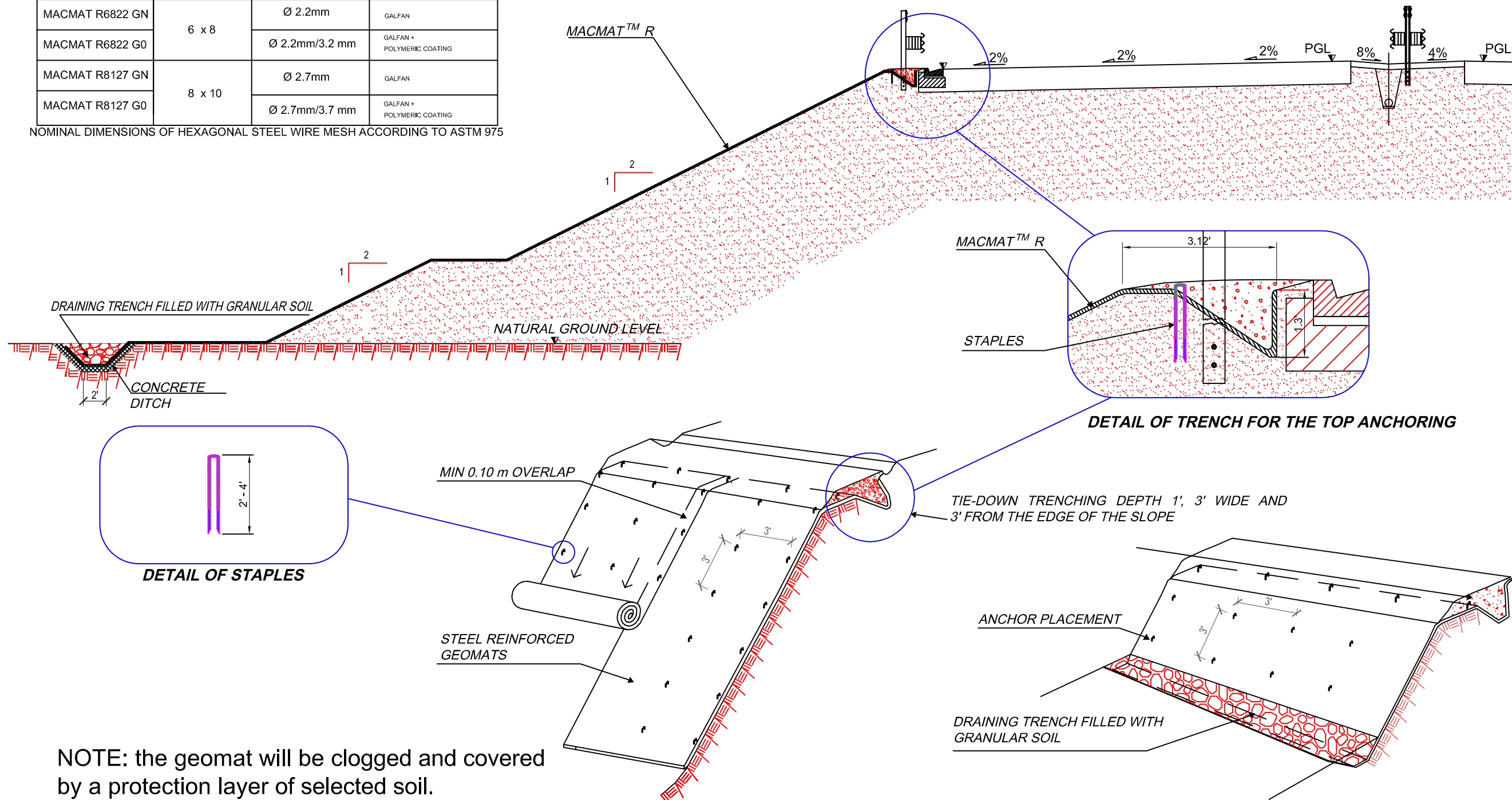

NOTE: the geomat will be clogged and covered by a protection layer of selected soil.

| | | | |
|--|-------------------|--------|------------|
| Maccaferri, Inc. provides this document and other data for Buyer's information only. Maccaferri, Inc. sells only Products and not any architectural, design, engineering, procurement requirement review, construction, or other services that Buyer may require. Buyer is solely responsible for determining a Product's fitness for Buyer's use. See General Conditions of Sales Contract for Maccaferri, Inc. Products. | | | |
| Rev: | Issue / Revision: | Drawn: | App: Date: |

| | | | |
|--------------------------------|--------------------|--------------------|-----------------------|
| Drawing Title: MacMat R | | | |
| Project No: | Client: | --- | |
| Drawing No: 1 / 4 | Units: Feet | Scale: NTS | Rev: 1 |
| Printed on: 3/4/15 | | Checked: SM | Date: 05/30/14 |

| | |
|----------------------|-----------------------|
| Designed: --- | Date: --- |
| Drawn: SG | Date: 05/30/14 |
| Checked: SM | Date: 05/30/14 |

| | |
|----------|-----------------------------|
| Project: | TYPICAL DRAWING |
| | NOT FOR CONSTRUCTION |

MACCAFERRI

Maccaferri, Inc.
 10303 Governor Lane Blvd.
 Williamsport, MD 21795-3116 USA
 Ph. (301) 223-6910 Fax (301) 223-6134

This drawing is stored in: L:\Projects\Typ. Standard Details\Card Files\Drawing Library\MacMat R\MacMat R.dwg

TYPICAL SLOPE PROTECTION

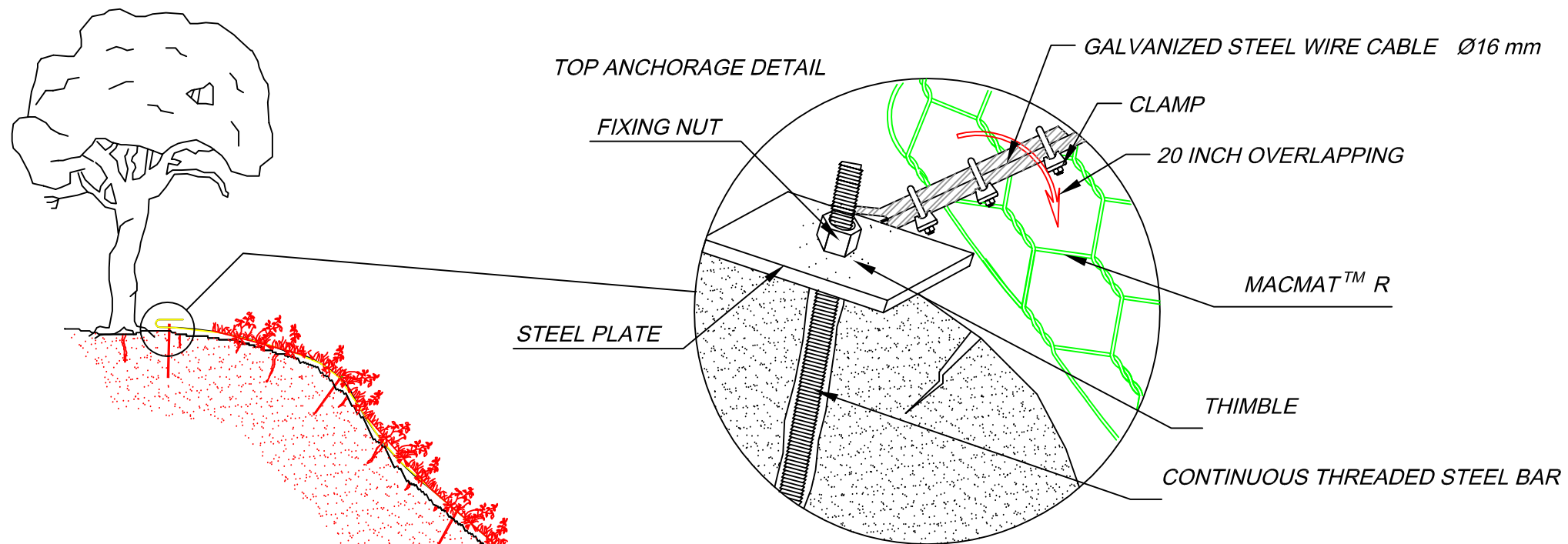

IN ORDER TO HAVE A GOOD VEGETATION SHALL BE MINIMIZED VOIDS BETWEEN THE SOIL AND THE REVETEMENT

SLOPE ANGLE FROM 35 TO 50° :
MACMAT™ R + HYDROSEEDING

VEGETATION GROWTH OVER MACMAT™ R:

- 1: DOUBLE TWIST STEEL WIRE MESH
- 2: 3D GEOMAT
- 3: IN-SITU SOIL
- 4: VEGETAL SOIL
- 5: VEGETATION

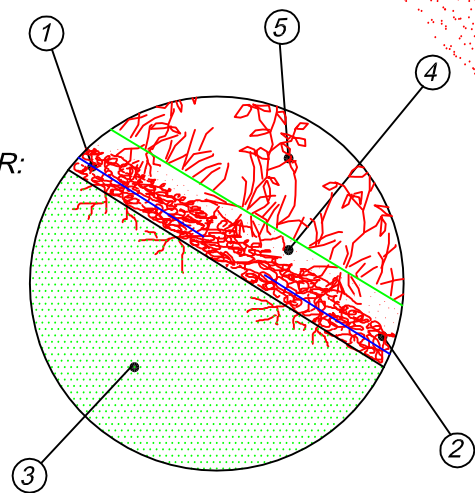

VEGETAL SOIL (5-10 cm)

TIMBER STAPLE

STANDARD DIMENSIONS TABLE - MACMAT R

| PRODUCT | MESH TYPE | WIRE DIAM. | COATING TYPE |
|-----------------|-----------|----------------|----------------------------|
| MACMAT R6822 GN | 6 x 8 | Ø 2.2mm | GALFAN |
| MACMAT R6822 G0 | | Ø 2.2mm/3.2 mm | GALFAN + POLYMERIC COATING |
| MACMAT R8127 GN | 8 x 10 | Ø 2.7mm | GALFAN |
| MACMAT R8127 G0 | | Ø 2.7mm/3.7 mm | GALFAN + POLYMERIC COATING |

NOMINAL DIMENSIONS OF HEXAGONAL STEEL WIRE MESH ACCORDING TO ASTM 975

Maccaferri, Inc. provides this document and other data for Buyer's information only. Maccaferri, Inc. sells only Products and not any architectural, design, engineering, procurement requirement review, construction, or other services that Buyer may require. Buyer is solely responsible for determining a Product's fitness for Buyer's use. See General Conditions of Sales Contract for Maccaferri, Inc. Products.

| Rev: | Issue / Revision: | Drawn: | App: | Date: |
|------|-------------------|--------|------|-------|
| | | | | |

| | | | | |
|--------------------------------|--|--------------------|------------|--------|
| Drawing Title: MacMat R | | | | |
| Project No: - | | Client: --- | | |
| Drawing No: 2 / 4 | | Units: Feet | Scale: NTS | Rev: 1 |
| | | Printed on: 3/4/15 | | |

| | |
|---------------|----------------|
| Designed: --- | Date: --- |
| Drawn: SG | Date: 05/30/14 |
| Checked: SM | Date: 05/30/14 |

Project: **TYPICAL DRAWING**

NOT FOR CONSTRUCTION



Maccaferri, Inc.
10303 Governor Lane Blvd.
Williamsport, MD 21795-3116 USA
Ph. (301) 223-6910 Fax (301) 223-6134

INSTALLATION DETAILS (1): OVERLAPPING

OVERLAPPING OPERATION OF MACMAT R

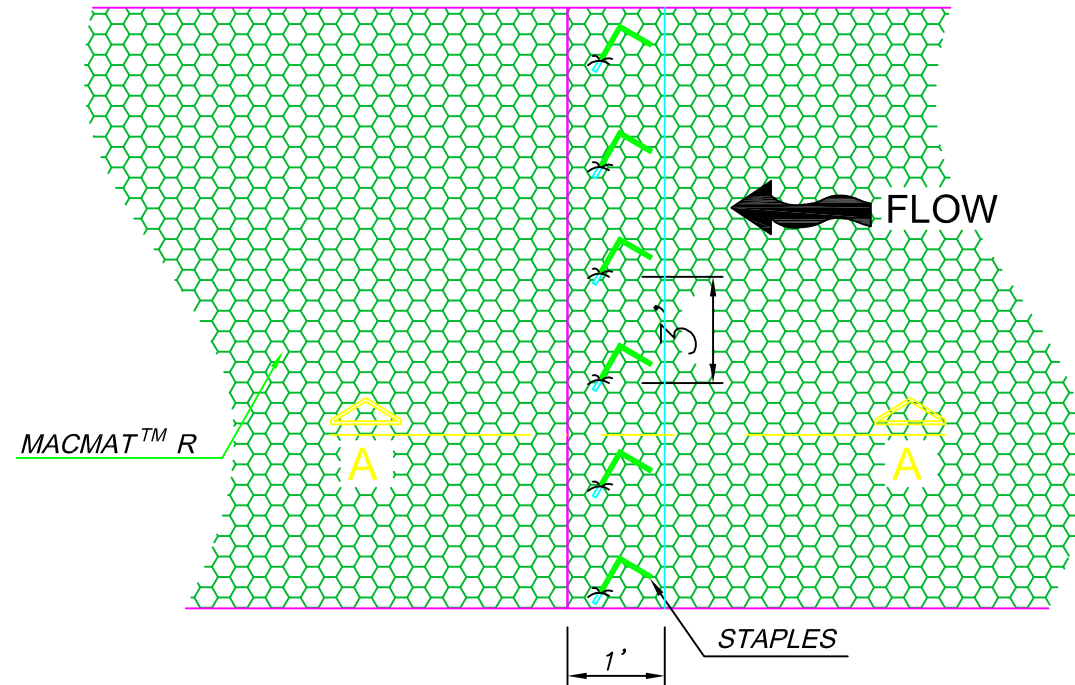

SECTION A-A

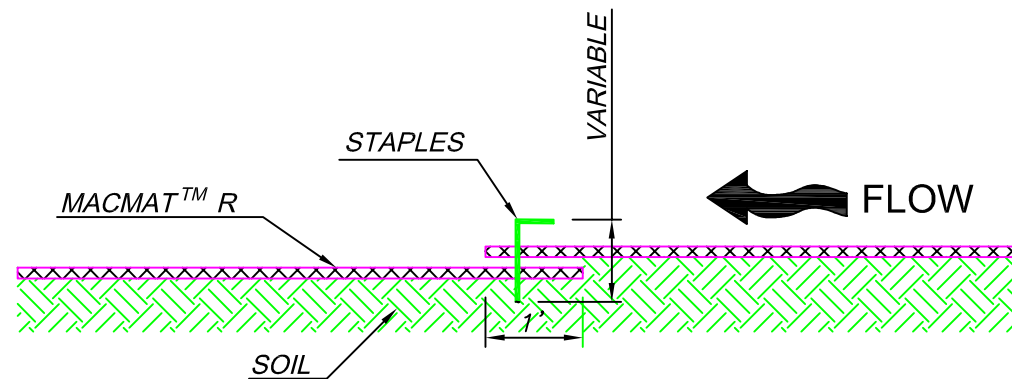

PANEL LACING

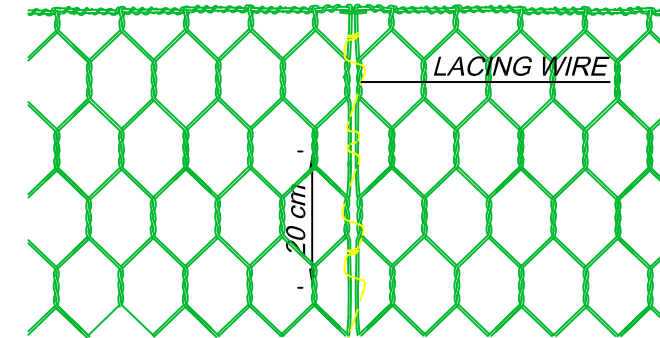

STANDARD DIMENSIONS TABLE - MACMAT R

| PRODUCT | MESH TYPE | WIRE DIAM. | COATING TYPE |
|-----------------|-----------|----------------|----------------------------|
| MACMAT R6822 GN | 6 x 8 | Ø 2.2mm | GALFAN |
| MACMAT R6822 G0 | | Ø 2.2mm/3.2 mm | GALFAN + POLYMERIC COATING |
| MACMAT R8127 GN | 8 x 10 | Ø 2.7mm | GALFAN |
| MACMAT R8127 G0 | | Ø 2.7mm/3.7 mm | GALFAN + POLYMERIC COATING |

NOMINAL DIMENSIONS OF HEXAGONAL STEEL WIRE MESH ACCORDING TO ASTM 975

Maccaferri, Inc. provides this document and other data for Buyer's information only. Maccaferri, Inc. sells only Products and not any architectural, design, engineering, procurement requirement review, construction, or other services that Buyer may require. Buyer is solely responsible for determining a Product's fitness for Buyer's use. See General Conditions of Sales Contract for Maccaferri, Inc. Products.

| | | | | | | | |
|-----------------------------------|-----------------------|---------------|----------------|------------------------|--------------------|-----------------------------|----------------|
| Drawing Title: MacMat R | | Designed: --- | Date: --- | Project: | | | |
| Project No: --- | Client: --- | Drawn: SG | Date: 05/30/14 | TYPICAL DRAWING | | | |
| Drawing No: 3/4 | Units: Feet | Scale: NTS | Rev: 1 | | | Checked: SM | Date: 05/30/14 |
| Rev: --- | Issue / Revision: --- | Drawn: --- | App: --- | Date: --- | Printed on: 3/4/15 | NOT FOR CONSTRUCTION | |

MACCAFERRI

Maccaferri, Inc.
10303 Governor Lane Blvd.
Williamsport, MD 21795-3116 USA
Ph. (301) 223-6910 Fax (301) 223-6134

INSTALLATION DETAILS (2): FIXING

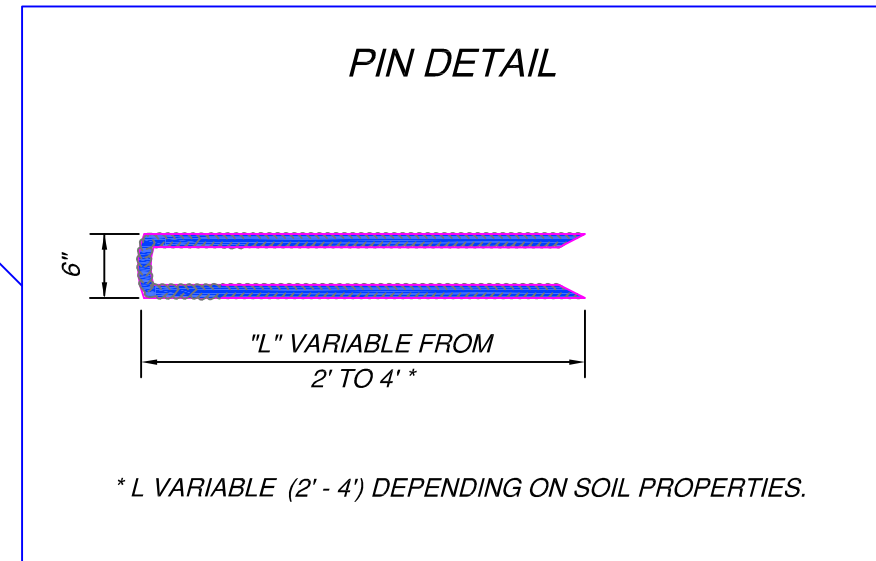
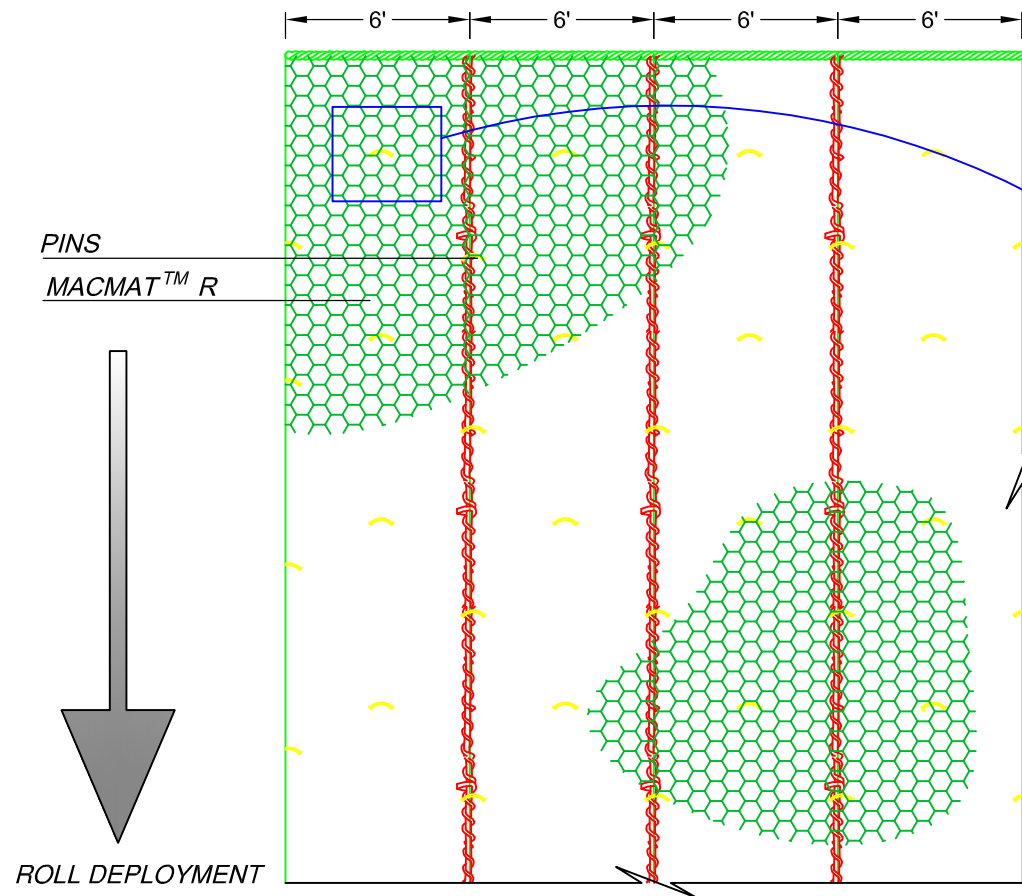

TOP ANCHORING

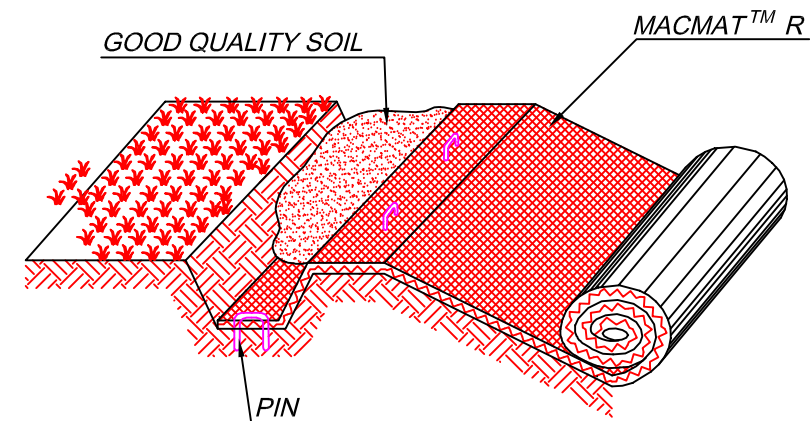

STANDARD DIMENSIONS TABLE - MACMAT R

| PRODUCT | MESH TYPE | WIRE DIAM. | COATING TYPE |
|-----------------|-----------|----------------|----------------------------|
| MACMAT R6822 GN | 6 x 8 | Ø 2.2mm | GALFAN |
| MACMAT R6822 G0 | | Ø 2.2mm/3.2 mm | GALFAN + POLYMERIC COATING |
| MACMAT R8127 GN | 8 x 10 | Ø 2.7mm | GALFAN |
| MACMAT R8127 G0 | | Ø 2.7mm/3.7 mm | GALFAN + POLYMERIC COATING |

NOMINAL DIMENSIONS OF HEXAGONAL STEEL WIRE MESH ACCORDING TO ASTM 975

Maccaferri, Inc. provides this document and other data for Buyer's information only. Maccaferri, Inc. sells only Products and not any architectural, design, engineering, procurement requirement review, construction, or other services that Buyer may require. Buyer is solely responsible for determining a Product's fitness for Buyer's use. See General Conditions of Sales Contract for Maccaferri, Inc. Products.

| | | | | | |
|--------------------------------|-------------|---------------|----------------|------------------------|-----------------------------|
| Drawing Title: MacMat R | | Designed: --- | Date: --- | Project: | |
| Project No: --- | Client: --- | Drawn: SG | Date: 05/30/14 | TYPICAL DRAWING | |
| Drawing No: 4 / 4 | Units: Feet | Scale: NTS | Rev: 1 | | |
| Printed on: 3/4/15 | | | | | NOT FOR CONSTRUCTION |



Maccaferri, Inc.
10303 Governor Lane Blvd.
Williamsport, MD 21795-3116 USA
Ph. (301) 223-6910 Fax (301) 223-6134